

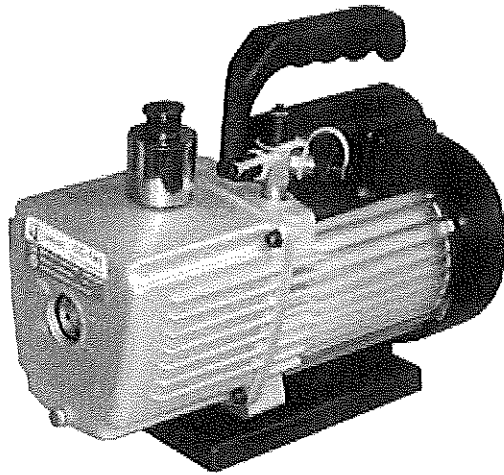

CC Series VACUUM PUMPS



OPERATING MANUAL

CC Series Vacuum Pump

Where price is a major consideration the Economy CC Series fits the bill. Available in a wide range of capacities the Economy vacuum pumps are ideal for low duty applications such as automotive or commercial air conditioning service. These pumps are exclusive to JAVAC and as such are supported by JAVAC Australia wide.

The Economy Range are 2 stage oil sealed vacuum pumps, have ultimate vacuums of 25 microns and feature an oil de-mister to reduce oil spillage. All pumps come with a tri-connector suitable for 1/4 SAE, 3/8 SAE and 1/2 ACME.

The Economy Vacuum Pump Series supplied by JAVAC are covered by a 12 month warranty.

Model	Pumping Speed	Part No.	
CC-45	45 litre/min	GE3658-01 (TECHNOS PART NUMBER) JAVAC PART NUMBER: VCQ45-2	

Javac Pty Ltd

Pump components

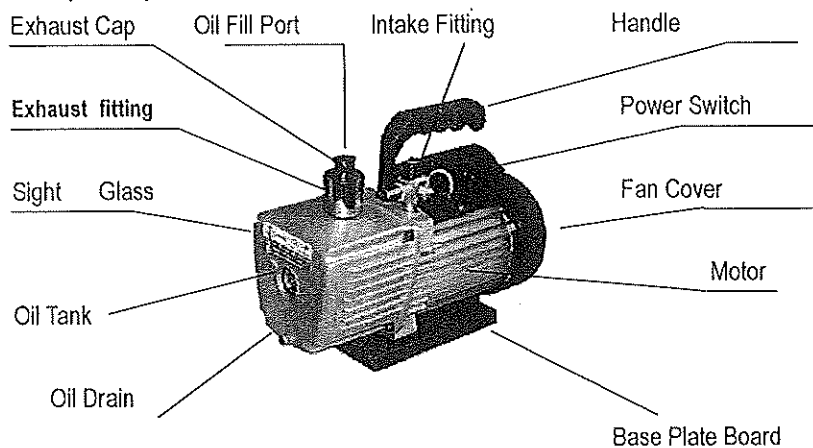

Javac Pty Ltd

Before starting: -

Add vacuum pump oil and always check the oil level before use. Low oil level or poor quality oil will result in premature wear and poor performance.

Install on a flat surface with adequate ventilation; allow 5cm on all sides of the pump. Remove the intake and exhaust fitting cap and connect via a suitable hose to a manifold or suitable circuit.

Connect to a suitable safe power source using earth leakage devices when using extension cords.

Caution:

- 1) Do not use with combustible, explosive, poisonous or reactive/corrosive gases.
- 2) Do not allow dust particles to enter the pump.
- 3) Do not allow the pump to run to open air / atmosphere for more than 3 minutes;
- 4) Do not allow the inlet temperature of gases to exceed 80°C. Do not use in environments over 50°C;
- 5) Not suitable for use as a compressor, transfer pump or recovery pump.
- 6) Do not operate without oil.
- 7) Pump surface may be hot.
- 8) Do not block air outlet when pump is in use.
- 9) Suitable for indoor use only.

Javac Pty Ltd

Trouble Shooting

Symptom	Suggestion?	Solution
Poor vacuum	1. Oil insufficient	Add oil to center line of sight glass
	2. Pump oil emulsified, not clean	Replace with new oil
	3. Oil inlet blocked or oil feeding inadequate	Clean oil inlet and filtering screen
	4. Pump hose or vessel leak	Check hose and vessel for leakage and repair
	5. Improper pump chosen	Pump too small – use larger pump
	6. Worn components	Repair or replace with a new pump
Oil leakage	1. Oil seal damaged	Replace with a new oil seal
	2. Oil casing gasket loose or damaged	Tighten screws or replace O-type ring
Oil discharge	1. Too much oil	Drain oil to oil base line on sight glass
	2. Inlet pressure too high	Use recovery pump to remove pressure
Starting problems - overheating	1. Temperature below +5C	Allow temperature to rise
	2. Motor overloaded.	Wait 5 minutes, re start, or press motor reset if installed.
	3. Foreign matter falling in the pump	Check and eliminate the foreign matter
	4. Low voltage	Avoid long extension leads.
	5. Overheated	Check fan, ventilation and repair
	6. SAFETY If in any doubt.	Consult JAVAC

Javac Pty Ltd

Exploded Drawing

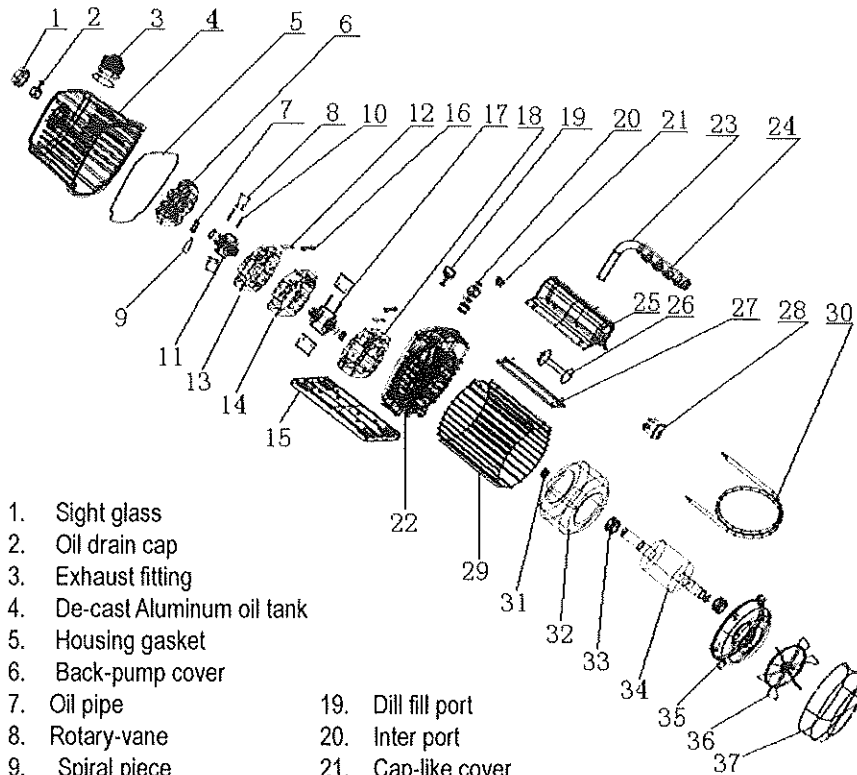

- | | | |
|------------------------------|--|------------------|
| 1. Sight glass | | |
| 2. Oil drain cap | | |
| 3. Exhaust fitting | | |
| 4. De-cast Aluminum oil tank | | |
| 5. Housing gasket | | |
| 6. Back-pump cover | | |
| 7. Oil pipe | | |
| 8. Rotary-vane | | |
| 9. Spiral piece | | |
| 10. Rotary-vane spring | | |
| 11. Back-pump rotor | | |
| 12. Valve piece | | |
| 13. Back-pump stator | | |
| 14. Middle fence | | |
| 15. Molded base | | |
| 16. Restricting piece | | |
| 17. Front pump rotor | | |
| 18. Front pump stator | | |
| 19. Dill fill port | | |
| 20. Inter port | | |
| 21. Cap-like cover | | |
| 22. Trestle | | |
| 23. Handle | | |
| 24. Sleeve | | |
| 25. Cover | | 31. Shaft seat |
| 26. Capacitor | | 32. Motor Stator |
| 27. Board | | 33. Bearing |
| 28. Switch | | 34. Motor rotor |
| 29. Motor hull | | 35. Motor cover |
| 30. Outlet | | 36. Fan |
| | | 37. Fan cover |